



Solid 山西索立得工贸有限公司

Shanxi Solid Industrial Co.,Ltd.

DI JOINTS

DI



For years

we supply customers

quality goods with quick delivery,

we are still

trying our best to do better and better.

Your demand

is what we supply

Shanxi Solid Industrial Co.,Ltd.---

The company

you can rely on to be competitive!

**We are the castings specialist,
we are the pipeline specialist!**

SOLID Universal Series DN40 to DN600 PN10/16



Universal Tolerance

SOLID universal series is solution to most pipe connections. With up to 29 tolerances on the pipe OD it not only eases installation but also reduce the expensive and time consuming trial holes, reduce stock holding and increase stock turn over.



Pipe Materials

Maxi range is solution to Ductile Iron pipe , Cast Iron pipe, Concrete pipe, Steel pipe, Stainless Steel pipe, Asbestos Cement pipe, PVC pipe, Copper pipe, GRP pipe and ABS pipe.

Universal Flange Adaptor DN40 to DN600 PN10/16

SIZE	RANGE	A	D	L	Qty
DN40	48-63	165	165	M12*130	2
DN50	59-72	180	187	M12*130	2
DN65	72-85	180	222	M12*130	2
DN80	88-103	190	227	M12*130	4
DN100	93-117	204	227	M12*130	4
DN100	107-128	214	227	M12*130	4
DN125	138-153	250	287	M12*130	4
DN150	155-175	278	287	M12*140	4
DN150	159-182	278	287	M12*140	4
DN175	192-210	300	340	M12*140	4
DN200	218-235	324	340	M12*140	4
DN225	250-267	406	402	M12*140	4
DN250	235-252	406	402	M12*140	4
DN250	271-289	406	406	M12*140	4
DN300	315-332	440	482	M12*140	6
DN300	322-339	452	482	M12*140	6
DN300	324-350	463	482	M12*140	6
DN300	345-375	510	520	M12*180	8
DN350	374-391	510	520	M16*180	8
DN400	400-429	560	580	M16*180	8
DN400	417-437	560	580	M16*180	8
DN400	455-472	560	580	M16*180	8
DN450	480-500	630	640	M16*180	10
DN500	500-535	700	715	M16*180	10
DN500	526-546	700	715	M16*180	10
DN500	555-572	700	715	M16*180	10
DN600	600-630	830	840	M16*180	10
DN600	630-650	830	840	M16*180	10

Materials & Relevant Standards

END RING : DUCTILE IRON GGG-50
 BODY : DUCTILE IRON GGG-50
 GASKET : EPDM / NBR / SBR
 BOLTS & NUTS : CARBON STEEL/SS304
 / SS316
 COATING : EPOXY coating.

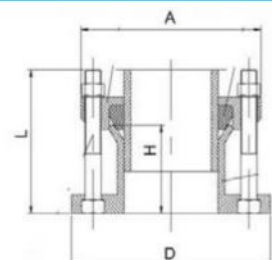

Universal Coupling DN40 to D600 PN10/16

SIZE	RANGE	A	L	L	Qty
DN40	48-63	165	100	M12*180	2
DN50	59-72	180	95	M12*180	2
DN65	72-85	180	95	M12*180	3
DN80	88-103	190	95	M12*180	4
DN100	93-117	200	95	M12*180	4
DN100	107-128	214	95	M12*180	4
DN125	138-153	250	95	M12*180	4
DN150	155-175	278	105	M12*200	4
DN150	159-182	278	105	M12*200	4
DN175	192-210	300	130	M12*220	4
DN200	218-235	324	130	M12*220	4
DN225	250-267	406	130	M12*230	6
DN250	235-252	406	130	M12*230	6
DN250	271-289	440	130	M12*230	6
DN300	315-332	452	130	M12*230	6
DN300	322-339	463	130	M12*230	6
DN300	324-350	510	165	M12*230	6
DN300	345-375	510	165	M12*230	6
DN350	374-391	510	165	M16*250	8
DN400	400-429	560	165	M16*250	8
DN400	417-437	560	165	M16*250	8
DN400	455-472	560	165	M16*250	8
DN450	480-500	560	165	M16*250	8
DN500	500-535	560	165	M16*250	8
DN500	526-546	630	165	M16*250	8
DN500	555-572	700	165	M16*250	10
DN600	600-630	700	165	M16*250	10
DN600	630-650	700	165	M16*250	10

Materials & Relevant Standards

END RING : DUCTILE IRON GGG-50
 BODY : CARBON STEEL / DUCTILE IRON
 GASKET : EPDM / NBR / SBR
 BOLTS & NUTS : CARBON STEEL/SS304
 / SS316
 COATING : EPOXY coating.

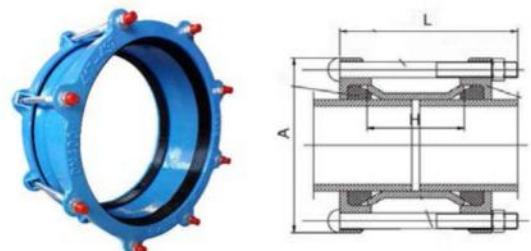

Dismantling Joint DN40 to DN2000 PN10/16

SIZE	PN10							PN16						
	D2	D4	D5	ØdxN	L1	L2	D2	D4	D5	ØdxN	L1	L2		
DN40	56	110	150	M16×280	4	190	280	56	110	150	M16×280	4	190	280
DN50	66	125	165	M16×280	4	190	280	66	125	165	M16×280	4	190	280
DN60	77	135	175	M16×280	4	210	280	77	135	175	M16×280	4	210	280
DN65	82	145	185	M16×280	4	210	280	82	145	185	M16×280	4	210	280
DN80	98	160	200	M16×310	8	220	310	98	160	200	M16×310	8	220	310
DN100	118	180	220	M16×310	8	220	310	118	180	220	M16×310	8	220	310
DN125	144	210	250	M16×310	8	220	310	144	210	250	M16×310	8	220	310
DN150	170	240	285	M20×320	8	220	320	170	240	285	M20×320	8	220	320
DN200	222	295	340	M20×340	8	240	340	222	295	340	M20×340	12	240	340
DN250	274	350	400	M20×360	12	250	360	274	355	400	M24×370	12	250	370
DN300	326	400	455	M20×360	12	260	360	326	410	455	M24×410	12	260	390
DN400	429	515	565	M24×370	16	275	370	429	525	580	M27×430	16	275	410
DN500	532	620	670	M24×390	20	285	390	532	650	715	M30×440	20	285	440
DN600	632	725	780	M27×410	20	305	410	632	770	840	M33×480	20	305	460
DN700	735	840	895	M27×410	24	305	410	735	840	910	M33×480	24	305	480
DN800	842	950	1015	M30×460	24	325	460	842	950	1025	M36×520	24	325	520
DN900	945	1050	1115	M30×460	28	325	460	945	1050	1125	M36×520	28	325	520
DN1000	1048	1160	1230	M33×480	28	345	480	1048	1170	1255	M39×560	28	345	560
DN1100	1152	1270	1340	M33×480	32	345	480	1152	1270	1355	M39×560	32	345	560
DN1200	1255	1380	1455	M36×520	32	345	520	1255	1390	1485	M45×600	32	345	600
DN1400	1462	1590	1675	M39×560	36	375	560	1462	1590	1685	M45×630	36	375	630
DN1500	1565	1700	1785	M39×590	36	410	590	1565	1710	1820	M52×660	36	410	665
DN1600	1668	1820	1915	M45×600	40	410	600	1668	1820	1930	M52×680	40	410	700
DN1800	1875	2020	2115	M45×640	44	425	640	1875	2020	2130	M52×680	44	425	730
DN2000	2082	2230	2325	M45×640	48	435	640	2082	2230	2345	M56×680	48	435	730

Materials & Relevant Standards

BODY : DUCTILE IRON GGG-50
 GASKET : EPDM / NBR / SBR
 BS EN 681-1
 BOLTS & NUTS : CARBON STEEL
 COATING : EPOXY coating.
 FLANGES AND DRILLINGS : ISO7005-2
 (BS EN1092-2:1997,DIN2501)

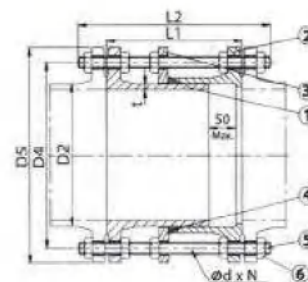

Dismantling Joint DN40 to DN2000 PN25

SIZE	PN25						
	D2	D4	D5	ØdxN	L1	L2	
DN40	56	110	150	M16×280	4	190	280
DN50	66	125	165	M16×280	4	190	280
DN60	77	135	175	M16×280	4	210	280
DN65	82	145	185	M16×280	4	210	280
DN80	98	160	200	M16×330	8	220	330
DN100	118	190	235	M20×340	8	220	340
DN125	144	220	270	M24×370	8	220	370
DN150	170	250	300	M24×370	8	220	370
DN200	222	310	360	M24×370	12	240	370
DN250	274	370	425	M27×410	12	250	410
DN300	326	430	485	M27×410	16	260	410
DN400	429	550	620	M33×480	16	280	480
DN500	532	660	730	M33×480	20	285	480
DN600	632	770	845	M36×520	20	315	520
DN700	735	875	960	M39×560	24	315	560
DN800	842	990	1085	M45×600	24	330	600
DN900	945	1090	1185	M45×600	28	345	600
DN1000	1048	1210	1320	M52×650	28	375	650
DN1100	1152	1310	1420	M52×670	32	420	670
DN1200	1255	1420	1530	M52×700	32	450	700
DN1400	1462	1640	1755	M56x750	36	480	750
DN1600	1668	1860	1975	M56x800	40	510	800
DN1800	1875	2070	2195	M64x850	44	540	850
DN2000	2082	2300	2425	M64x920	48	580	920

Materials & Relevant Standards

BODY : DUCTILE IRON GGG-50
 GASKET : EPDM / NBR / SBR
 BS EN 681-1
 BOLTS & NUTS : CARBON STEEL
 COATING : EPOXY coating.
 FLANGES AND DRILLINGS : ISO7005-2
 (BS EN1092-2:1997,DIN2501)

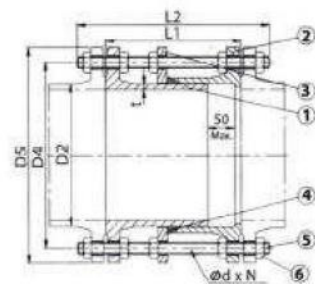



Maxi Range Tolerance

Maxi range is solution to most pipe connections. With up to 35mm tolerance on the pipe OD it not only eases installation but also reduce the expensive and time consuming trial holes, reduce stock holding and increase stock turn over.



Pipe Materials

Maxi range is solution to Ductile Iron pipe , Cast Iron pipe, Concrete pipe, Steel pipe, Stainless Steel pipe, Asbestos Cement pipe, PVC pipe, Copper pipe, GRP pipe and ABS pipe.

Maxi Range Flange Adaptor DN40 to D700 PN10/16

SIZE	RANGE	H	L	Qty
DN50	46-76	73	M12×130	2
DN50	57-74	73	M12×130	2
DN50/65	63-85	73	M12×130	4
DN80	84-107	73	M12×130	4
DN100	99-119	76	M12×130	4
DN100	107-133	76	M12×130	4
DN125	132-159	76	M12×130	4
DN150	157-184	76	M12×130	4
DN175/200	184-207	76	M12×130	4
DN200	206-230	85	M12×140	4
DN200	216-246	85	M12×140	4
DN225/250	242-268	85	M12×140	4
DN250	266-297	85	M12×140	6
DN250	280-306	85	M12×160	6
DN300	301-327	90	M12×140	6
DN300	314-349	90	M12×140	6
DN300	324-350	90	M12×140	6
DN300	345-375	110	M12×200	6
DN350	386-415	130	M16×230	8
DN400	386-415	130	M16×230	8
DN400	408-436	108	M16X180	8
DN400	425-459	108	M14×180	8
DN400	470-505	120	M14×180	8
DN450	457-492	108	M14×180	10
DN500	530-565	108	M14×180	10
DN600	610-645	108	M14×180	10
DN700	710-745	118	M16×200	12

Materials & Relevant Standards

END RING : DUCTILE IRON GGG-50
 BODY : DUCTILE IRON GGG-50
 GASKET : EPDM / NBR / SBR
 BOLTS & NUTS : CARBON STEEL/SS304
 / SS316
 COATING : EPOXY coating

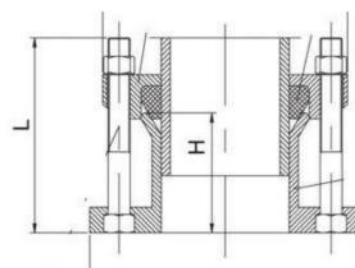

Maxi Range Coupling DN40 to DN700 PN10/16

SIZE	RANGE	H	L	Qty
DN50	46-76	102	M12×180	2
DN50	57-74	102	M12×180	2
DN50/65	63-85	102	M12×180	4
DN80	84-107	102	M12×180	4
DN100	99-119	102	M12×200	4
DN100	107-133	102	M12×200	4
DN125	132-159	102	M12×200	4
DN150	157-184	102	M12×200	4
DN175/200	184-207	102	M12×200	4
DN200	208-225	102	M12×200	4
DN200	216-246	102	M12×200	4
DN225/250	242-268	110	M12×220	4
DN250	266-297	130	M12×230	6
DN250	280-306	130	M12×230	6
DN300	301-327	130	M12×230	6
DN300	314-349	130	M12×230	6
DN300	324-350	130	M12×230	6
DN300	345-375	130	M12×230	6
DN350/400	386-415	130	M16×260	8
DN400	408-436	130	M16×260	8
DN400	425-459	130	M14×250	8
DN400	470-505	130	M14×250	8
DN450	457-492	130	M14×250	8
DN500	530-565	130	M16×260	10
DN600	610-645	130	M16×260	10
DN700	710-745	160	M16×310	12

Materials & Relevant Standards

END RING : DUCTILE IRON GGG-50
 BODY : DUCTILE IRON GGG-50 /
 CARBON STEEL
 GASKET : EPDM / NBR / SBR
 BOLTS & NUTS : CARBON STEEL/SS304
 / SS316
 COATING : EPOXY coating

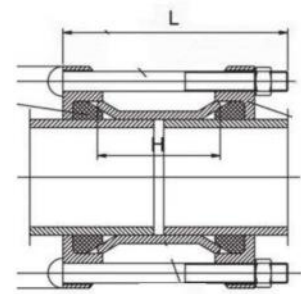

Flange Adaptor for PE pipes DN40 to DN300

DN	PIPE	D	K	b	L	E	Bolts		Weight
	OD						L	Qty	kg
40	50	150.0	112				M10*35	2	
50	63	165.0	125	19	90	80	M10*35	2	4.1
60	63	175.0	135	19	90	80	M10*35	2	4.2
60	75	175.0	138	19	92	82	M10*35	2	5.15
65	63	185.0	145	19	90	80	M10*35	2	4.31
65	75	185.0	145	19	92	82	M10*35	2	5.6
80	75	200.0	160	19	92	82	M10*35	2	5.9
80	90	200.0	160	19	95	85	M10*35	4	7.1
100	90	220.0	180	19	95	85	M10*35	4	7.5
100	110	220.0	180	19	95	85	M10*35	4	8.9
100	125	220.0	180	19	97	87	M10*35	4	11.21
125	110	250.0	210	19	95	85	M10*35	4	9.76
125	125	250.0	210	19	97	87	M10*35	4	13.1
125	140	250.0	210	19	103	93	M10*35	4	14.1
150	140	285.0	240	19	103	93	M10*35	4	14.32
150	160	285.0	240	19	115	105	M12*40	4	14.89
150	180	285.0	240	19	125	115	M12*40	4	16.12
200	200	340.0	295	20	135	125	M12*45	4	17.86
200	225	340.0	295	20	138	128	M12*45	4	19.86
250	250	400.0	350	22	155	145	M12*45	6	23.89
250	280	400.0	350	22	158	148	M12*45	6	24.91
300	315	455.0	400	25	184	174	M12*50	6	34.12
300	355	455.0	400	25	277	237	M12*50	6	42

Materials & Relevant Standards

BODY : DUCTILE IRON GGG-50
 GASKET : EPDM
 GRIP RING : BRASS
 BOLTS & NUTS : A2 STAINLESS STEEL
 COATING : EPOXY coating.

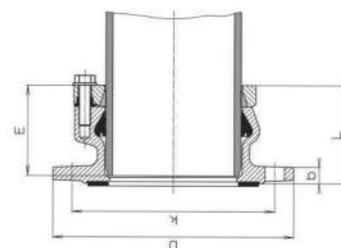

Coupling for PE pipes OD63 to OD355

PIPE OD	L	E	B	Bolts		Weight kg
				L	Qty	
63	171	80	124	M10*35	4	3.26
75	175	82	138	M10*35	4	4.19
90	181	85	152	M10*35	8	5.89
110	181	85	172	M10*35	8	6.95
125	185	87	193	M10*35	8	7.91
140	197	93	210	M10*35	8	9.12
160	221	105	236	M12*40	8	12.04
180	241	113	258	M12*40	8	14.13
200	261	125	284	M12*45	8	16.12
225	265	128	314	M12*45	8	18.19
250	300	145	347	M12*45	12	22.14
280	306	148	376	M12*45	12	25.67
315	358	174	422	M12*50	12	34.12
355	464	237	472			
355	-	-	-	-	-	-
400	-	-	-	-	-	-
400	-	-	-	-	-	-
455	-	-	-	-	-	-
500	-	-	-	-	-	-
500	-	-	-	-	-	-
630	-	-	-	-	-	-
710	-	-	-	-	-	-
800	-	-	-	-	-	-

Materials & Relevant Standards

BODY : DUCTILE IRON GGG-50
 GASKET : EPDM
 GRIP RING : BRASS
 BOLTS & NUTS : A2 STAINLESS STEEL
 COATING : EPOXY coating.

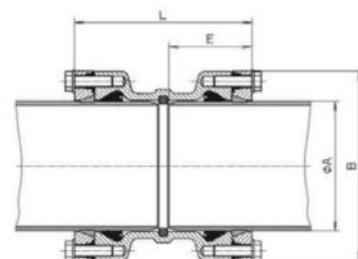

Flange Adaptor for PE pipes DN350 to DN800

DN	D	L	B	C
350PE	348-362	285.0	487	505
350PVC	393-407	485.0	532	505
350st	348-362	285.0	487	505
350zl	371-385	385.0	510	505
400PE	393-407	285.0	532	565
400PVC	443-457	485.0	582	565
400st	399-413	285.0	538	565
400zl	422-436	285.0	561	565
450PE/PVC	493-507	485.0	632	610
450zl	473-487	285.0	612	610
500PE	493-507	285.0	632	670
500PVC	553-567	485.0	692	670
500st	501-515	285.0	640	670
500zl	525-539	285.0	664	670
600PE/PVC	623-637	285.0	762	780
600st	603-617	285.0	742	780
600zl	628-642	285.0	767	780
700PE/PVC	703-717	285.0	842	895
700st	704-718	285.0	843	895
700zl	731-745	285.0	870	895
800PE/PVC	793-807	285.0	932	1015
800st	806-820	285.0	945	1015
800zl	835-849	285.0	974	1015

Materials & Relevant Standards

BODY : DUCTILE IRON GGG-50
 GASKET : EPDM
 RIM : 18G2A
 BOLTS & NUTS : Galv.STEEL
 COATING : EPOXY coating.

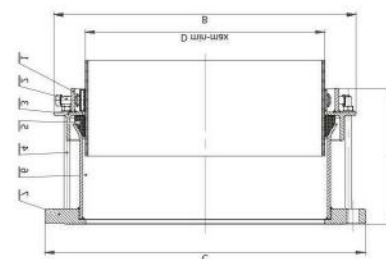

Quick Adaptor for PE/PVC pipes DN50 to DN400

Size	OD	D	L
DN 50	63	165	53
DN 60/65	63	185	53
DN 60/65	75	185	53
DN 80/90	90	200	57
DN 100	110	220	62
DN 125	125	250	67
DN 125	140	250	70
DN 150	160	285	70
DN 200	200	340	79
DN 200	225	380	85
DN 250	250	400	91
DN 300	315	455	106
DN 400	400	580	110

Materials & Relevant Standards

BODY : DUCTILE IRON GGG-50
 GASKET : EPDM / NBR / SBR
 GRIP : BRASS
 COATING : EPOXY coating.
 For PE is with brass grip.
 For PVC is non-brass grip.

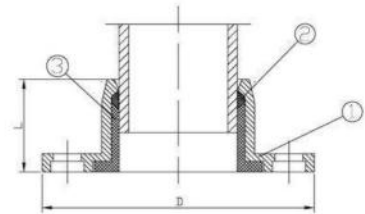

Quick Adaptor for DI pipes DN60 to DN400

Size	Pipe external diameter DE	L Overall length	D	D'	K	
DN 60/65	77	45	185	101	145	
DN 80	98	45	200	122	160	
DN 100	118	52	220	147	180	
DN 125	144	61	250	177	210	
DN 150	170	68	285	200	240	
DN 200	222	70	340	253	295	
DN 250	274	74	400	305	PN10 350	PN16 355
DN 300	326	77	455	361	PN10 400	PN16 410
DN 400	480	93	565	466	PN10 515	PN16 525

Materials & Relevant Standards

BODY : DUCTILE IRON GGG-50
 GASKET : EPDM / NBR / SBR
 COATING : EPOXY coating
 TEETH : SS304

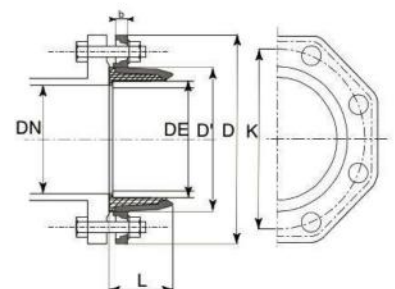

Tapping Saddle for PVC pipes OD50 to OD315

SIZE	R"	WIDTH	BOLTS	
			SIZE	QTY
50	3/4", 1", 1-1/4", 1-1/2", 2"	90	M10x30	4
63	3/4", 1", 1-1/4", 1-1/2", 2"	100	M10x35	4
75	3/4", 1", 1-1/4", 1-1/2", 2"	110	M10x40	4
90	3/4", 1", 1-1/4", 1-1/2", 2"	110	M10x40	4
110	3/4", 1", 1-1/4", 1-1/2", 2", 3"	110	M10x45	4
125	3/4", 1", 1-1/4", 1-1/2", 2", 3"	120	M12x50	4
140	3/4", 1", 1-1/4", 1-1/2", 2", 3"	150	M12x50	4
160	3/4", 1", 1-1/4", 1-1/2", 2", 3"	90	M12x55	4
180	3/4", 1", 1-1/4", 1-1/2", 2", 3"	100	M12x60	4
200	3/4", 1", 1-1/4", 1-1/2", 2", 3"	110	M12x60	4
225	3/4", 1", 1-1/4", 1-1/2", 2", 3"	110	M12x70	4
250	3/4", 1", 1-1/4", 1-1/2", 2", 3"	110	M12x70	4
280	3/4", 1", 1-1/4", 1-1/2", 2", 3"	120	M12x70	4
315	3/4", 1", 1-1/4", 1-1/2", 2", 3"	150	M12x80	4

Materials

BODY : DUCTILE IRON GGG-50
 GASKET : EPDM / NBR / SBR
 BOLTS & NUTS : A2 STAINLESS STEEL
 COATING : EPOXY coating



Tapping Saddle for DI pipes DN80 to DN300

DN	L	H	E	R
DN80	210	122	160	1"-2 1/2"
DN100	233	172	160	1"-2 1/2"
DN125	260	203	160	1"-2 1/2"
DN150	285	228	160	1"-2 1/2"
DN200	337	278	160	1"-2 1/2"
DN250	390	333	160	1"-2 1/2"
DN300	442	445	160	1"-2 1/2"

Materials & Relevant Standards

BODY : DUCTILE IRON GGG-50
 GASKET : EPDM / NBR / SBR
 BOLTS & NUTS : 6.8/8.8 Carbon Steel
 COATING : EPOXY coating.

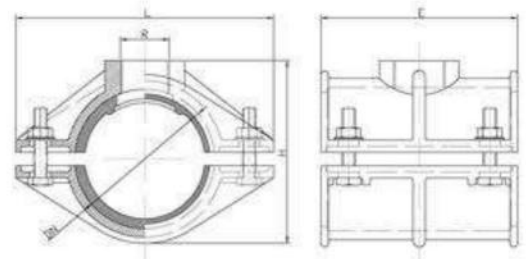

SPLIT COLLAR (three parts) OD50 to OD315

SIZE	OD
	RANGE
DN60	66-83
DN80	88-105
DN100	109-125
DN125	136-159
DN150	160-183
DN175	191-219
DN200	211-239
DN225	241-254
DN250	261-287
DN300	313-344
DN350	361-389

Materials & Relevant Standards

BODY : DUCTILE IRON GGG-50
 GASKET : EPDM / NBR / SBR
 BOLTS & NUTS : 6.8/8.8 Carbon Steel
 COATING : EPOXY coating.

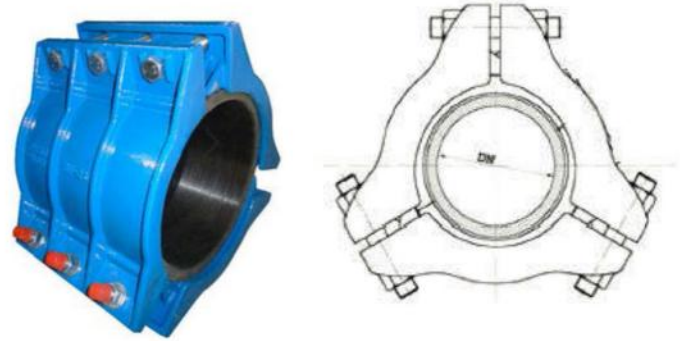

SPLIT COLLAR WITH FLANGED OUTLET

SIZE	FLANGE	OD
	dn	RANGE
DN60	60	66-83
DN80	60/80	88-105
DN100	60/80/100	109-125
DN125	60/80	136-159
DN150	60/80/100	160-183
DN175	60	191-219
DN200	60/80/100/150	211-239
DN225	60	241-254
DN250	60/80/100/125/150/200	261-287
DN300	60/80/100/125/150/200	313-344
DN350	60/80/100/125/150/200	361-389

Materials & Relevant Standards

BODY : DUCTILE IRON GGG-50
 GASKET : EPDM / NBR / SBR
 BOLTS & NUTS : 6.8/8.8 Carbon Steel
 COATING : EPOXY coating.

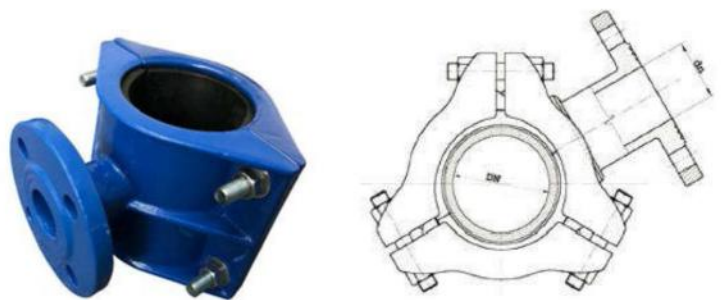

FLANGED OUTLET SADDLE DN110 to DN400

	PIPE OD	OUTLET DN	L	A	B
110/50	110	50	145	200	211
110/65	110	60/65	165	200	231
110/80	110	80	170	200	236
125/50	125	50	160	200	233
125/65	125	60/65	160	200	233
125/80	125	80	170	200	243
140/50	140	50	160	200	241
140/65	140	60/65	160	200	241
140/80	140	80	170	200	251
160/50	160	50	170	250	261
160/65	160	60/65	190	250	281
160/80	160	80	200	250	291
160/100	160	100	205	250	296
200/50	200	50	195	250	306
200/65	200	60/65	215	250	326
200/80	200	80	225	250	336
200/100	200	100	230	250	341
250/50	250	50	240	300	376
250/80	250	80	250	300	386
250/100	250	100	255	300	391
250/150	250	150	265	300	401
315/80	315	80	295	300	463
315/100	315	100	300	300	468
315/150	315	150	310	300	478
400/80	400	80	340	300	551
400/100	400	100	355	300	566
400/150	400	150	360	300	571

Materials & Relevant Standards

BODY : DUCTILE IRON GGG-50
 GASKET : EPDM
 BOLTS & NUTS : SS A2-70
 COATING : EPOXY coating.

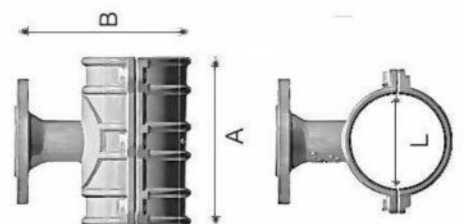

Gibault Joint for PVC pipes OD50 to OD500

SIZE	BOLTS		A	B	C	H
	SIZE	QTY				
50	M12x180	2	135	130	110	122
63	M12x180	2	140	145	120	132
75	M12x180	2	152	145	120	132
90	M12x180	3	170	150	120	132
110	M12x210	3	194	160	140	151
125	M12x210	4	209	175	140	151
140	M12x240	4	228	175	140	151
160	M12x240	4	250	175	140	152
200	M12x240	4	294	220	170	181
225	M12x240	6	321	220	170	181
250	M12x280	6	347	220	170	181
315	M12x280	6	414	220	175	185
400	M12x280	8	505	245	195	210
500	M12x280	10	618	245	195	210

Materials & Relevant Standards

BODY : DUCTILE IRON GGG-50
 GASKET : EPDM / NBR / SBR
 BOLTS & NUTS : CARBON STEEL
 COATING : EPOXY coating

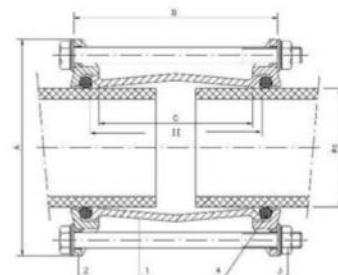

Blind Joint for PVC pipes OD50 to OD500 PN10/16

SIZE	D	L
50	52	57
63	66	65
75	78	67
90	93	73
110	113	80
125	128	79
140	143	81
160	163	71
180	—	—
200	204	92
250	254	97
315	319	112
400	406	136
450	457	144
500	—	—

Materials & Relevant Standards

END RING : DUCTILE IRON GGG-50
 BODY : DUCTILE IRON GGG-50
 GASKET : EPDM / NBR / SBR
 BOLTS & NUTS : CARBON STEEL
 COATING : EPOXY coating.

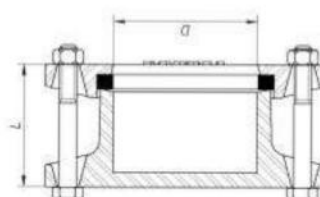

Spigot Joint DN50 to DN600 PN10/16

Size	Range (D min-max)
DN 50	62-68
DN 65	75-84
DN 80	94-100
DN 100	114-120
DN 150	166-173
DN 200	217-224
DN 250	270-276
DN 300	321-328
DN 350	373-380
DN 400	424-431
DN 500	527-534
DN 600	630-638

Materials & Relevant Standards

BODY : DUCTILE IRON GGG-50
 BOLTS&NUTS : Galvanized steel
 GASKET : EPDM / NBR / SBR
 COATING : EPOXY coating.
 ON REQUEST : bolts ,nuts and washers - galvanized or stainless steel

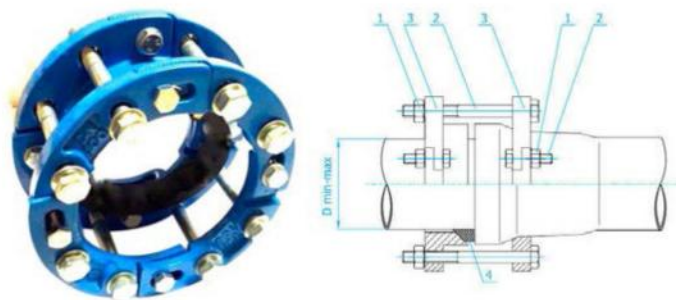

STEP COUPLING DN50 to DN300 PN10/16

OD RANGE 1	OD RANGE 2	A	B	C	D
59-72	72-85	181	168	128	220
72-85	88-103	201	181	128	220
88-103	108-128	208	201	128	220
108-128	138-153	244	228	128	220
159-182	192-210	300	289	128	220
192-210	218-235	335	300	165	220
218-235	250-267	358	335	165	250
250-267	272-289	398	375	165	250
272-289	315-332	415	398	165	250

Materials & Relevant Standards

END RING : DUCTILE IRON GGG-50
 BODY : CARBON STEEL / DUCTILE IRON
 GASKET : EPDM / NBR / SBR
 BOLTS & NUTS : CARBON STEEL
 COATING : EPOXY coating.

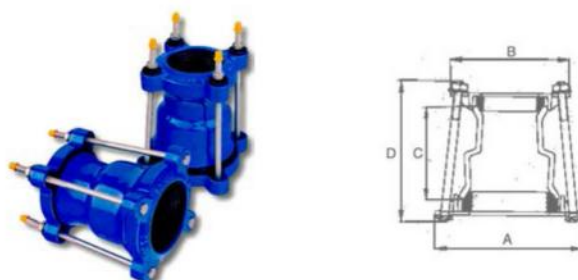



Shanxi Solid Industrial Co.,Ltd

ADD: 28F, No.8 Changxing South Street, Jinyuan District,
Taiyuan, Shanxi, China

Postcode: 030021

Tel1: 0086-351-8390369

Tel2: 0086-351-8390336

Fax: 0086-351-8390339

Email1: info@cnsolid.com

Email2: sales@cnsolid.com

Website: www.sxsolid.cn

